

**Ted Kaczynski's Letter  
Correspondence with the Tax  
Department**

# Contents

<b>County Assessment</b>	<b>3</b>
Lee to Ted . . . . .	3
Ted to Lee . . . . .	3
<b>Department of Revenue</b>	<b>5</b>

# County Assessment

## Lee to Ted

To: Theodore J Kaczynski  
P.O Box 524  
Lincoln, MT 59369

Subject: Low Income Classification

We are unable to allow the low income reduction Property taxes. The form you filled out last year (copy faxed) listed your income as \$74.50 for the entire year.

We felt no one could survive on an income that low for the entire year. We were unable to contact you by phone, we did mail a letter to you asking for additional information (I was not ...). Please fill out and return by Mar. 1

Lee Williams

## Ted to Lee

Leele "Lee" Williams  
Lewis and Clark County Assessment  
316 N. Park  
Helena MT 59623

Dear Ms. Williams:

You will notice that ...  
on my 1994 prop ...  
application was listed ...  
stopped to think for a ...  
occurred to you that ...  
[cross out] this interest ...  
deposited in a bank ...  
been living off that in ...  
fact, that is exactly wh\_\_ ...  
living off money I had ...  
money was not income fo\_\_ ...  
deposited several years ...  
costs me very litte ...  
I have no decadent mod\_\_ ...  
telephone or electricity ...  
grow most of my own ...  
I never received th\_\_ ...  
to in your note of ...  
On the ...

# Department of Revenue

## **Important information on Property Reappraisal**

You recently received your 1986 property assessment. It reflected the 1986 reappraisal values.

The June Special Session of the Montana Legislature asked us to be sure you understand your opportunity to appeal the new appraisal. These rights are particularly important to you because our records show that your property values increased more than the state wide average.

The attached fact sheet explains the increase in taxable value for your property

If you disagree with the appraisal, the Legislature has extended the appeal deadline to 15 days after you receive this notice.

Our appraisal office in your county will be happy to explain how your values were determined. Please give them a call and set up a time to discuss your questions or concerns.

Sincerely ...

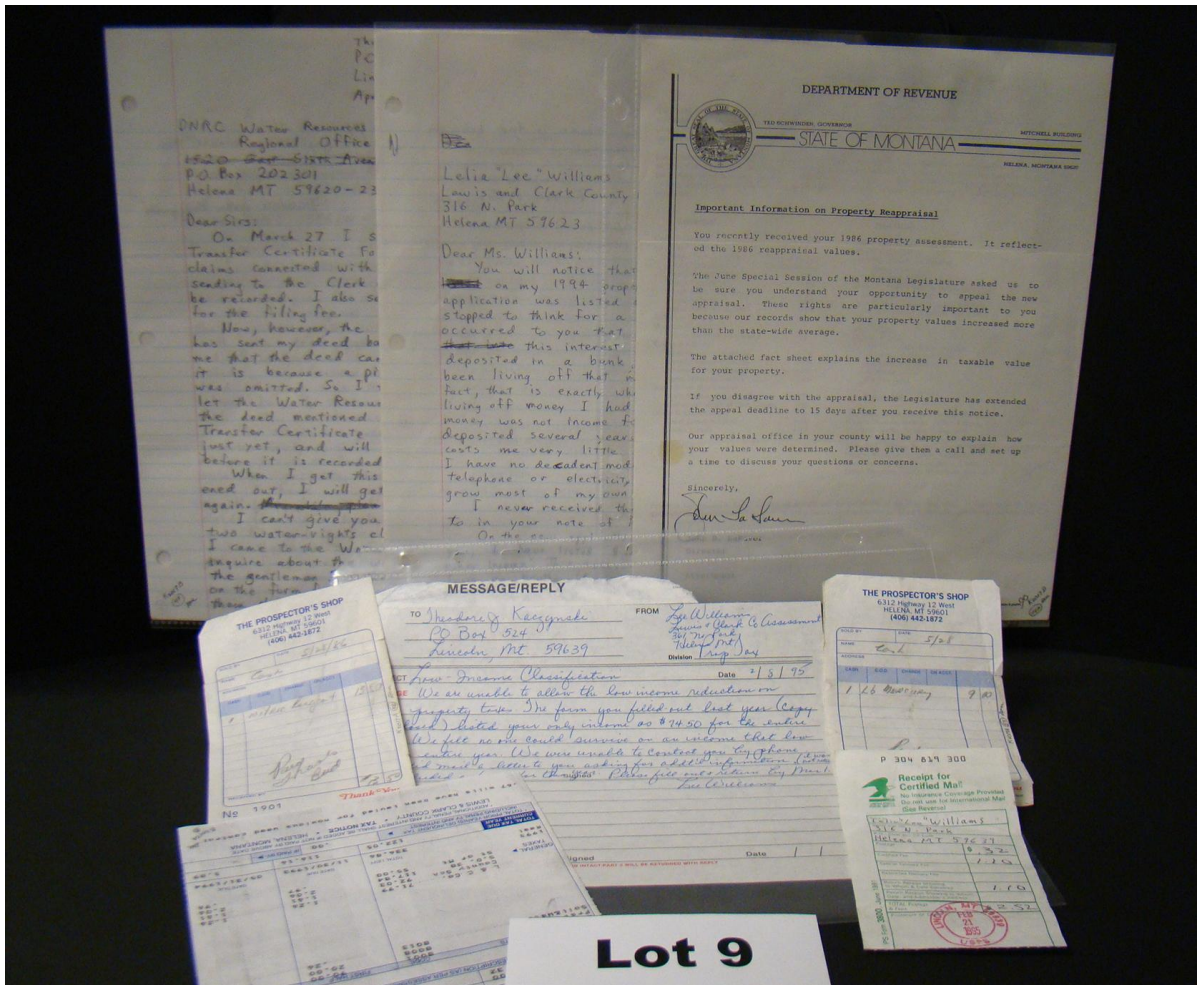

## The Ted K Archive

Ted Kaczynski's Letter Correspondence with the Tax Department

<[flickr.com/photos/usmarshals/](https://www.flickr.com/photos/usmarshals/)>

**[www.thetedkarchive.com](http://www.thetedkarchive.com)**